

# FASTIVAL INSTALLATION MANUAL

1

## Necessary material

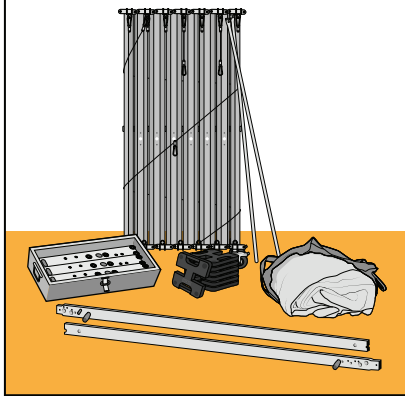

Structure  
Power Poles and its cable  
Outside Membrane Bar  
Membrane  
Outside Membrane  
Feet in their box  
Weights

2

## Remove the two long locking cable

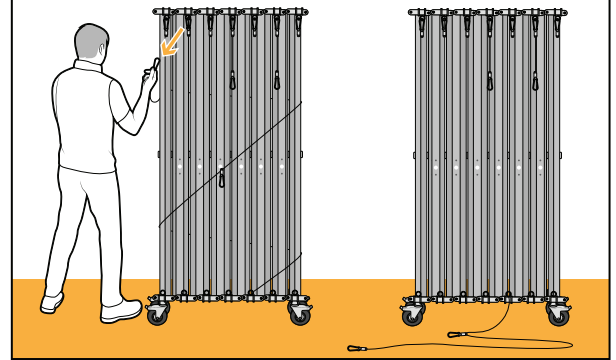

*Let them lay on the side of the structure*

3

## Pull the structure open

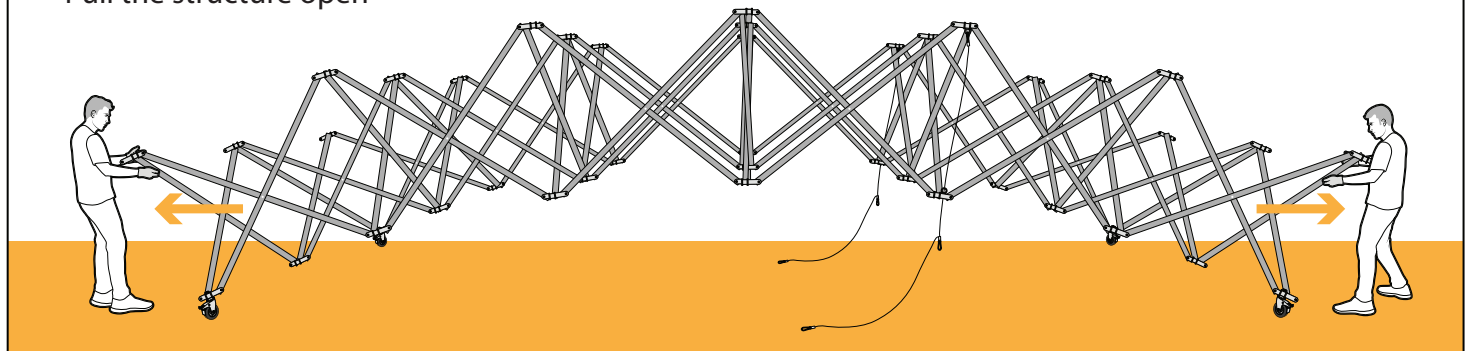

4

## Secure the red carabiner of the two long locking cables to the red eyebolts

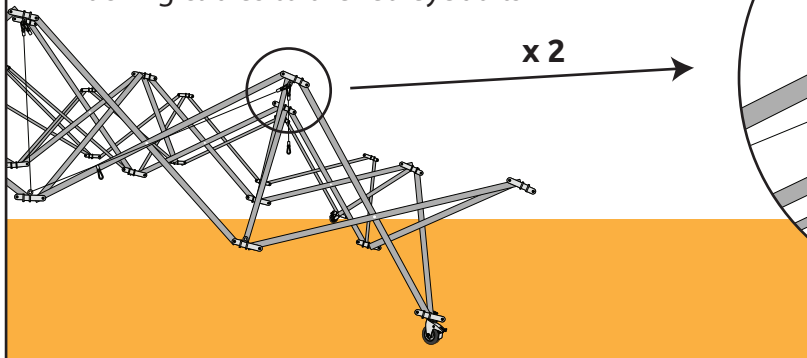

x 2

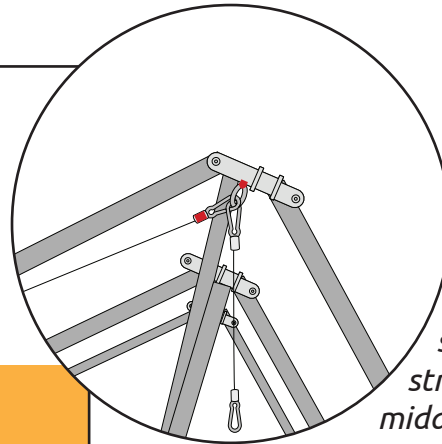

*If the cable is too short, lift the structure in the middle*

5

## Put one break

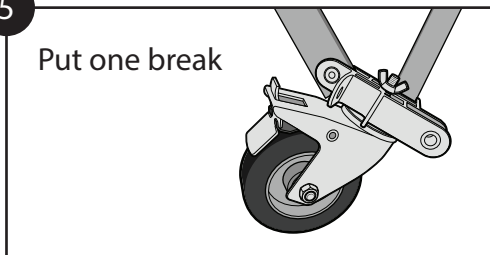

6

## Install the outside membrane bar

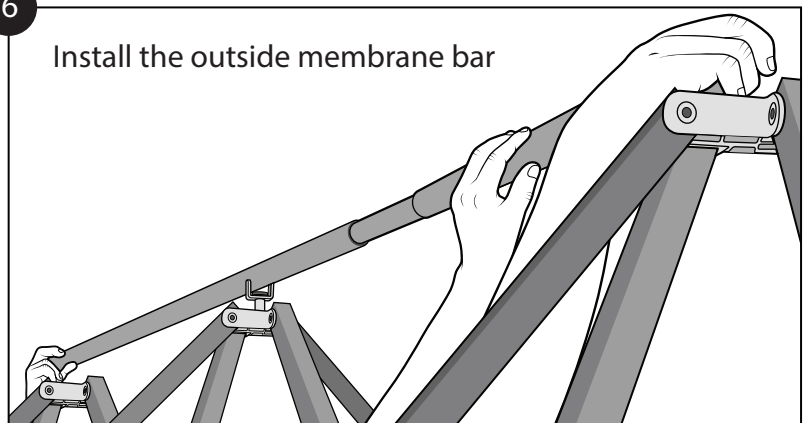

*First install the middle support and then screw the bar on both sides*

7

Install the outside membrane

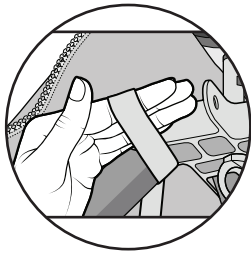

Keep the straps loose  
(4 fingers) for the external  
and middle row

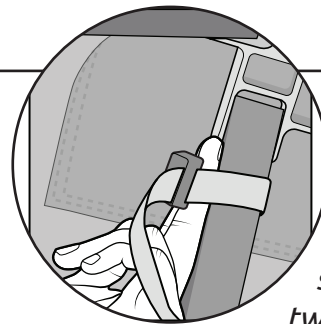

For all the others  
straps, only keep  
two fingers in  
between

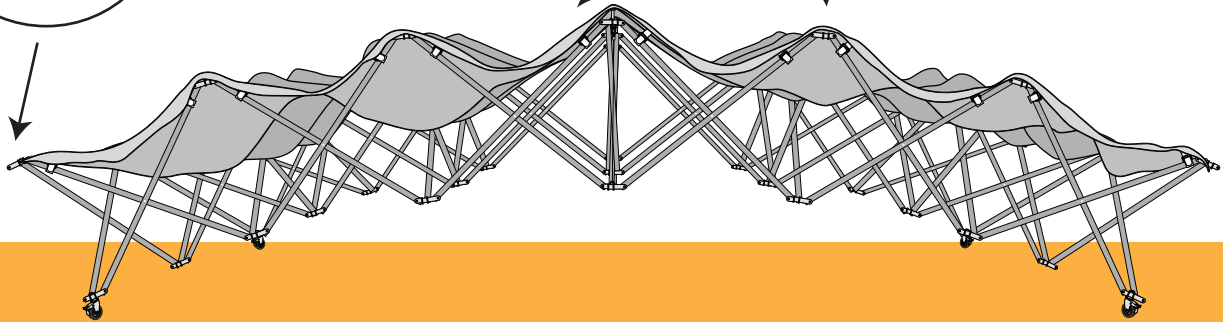

Close the membrane until the next joint  
and attach the backdrop cable to the zipper

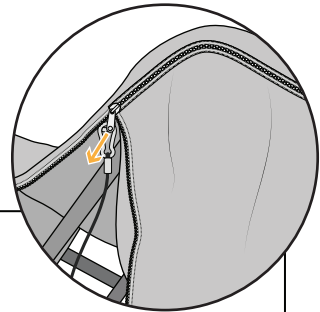

8

Partially attach the backdrop

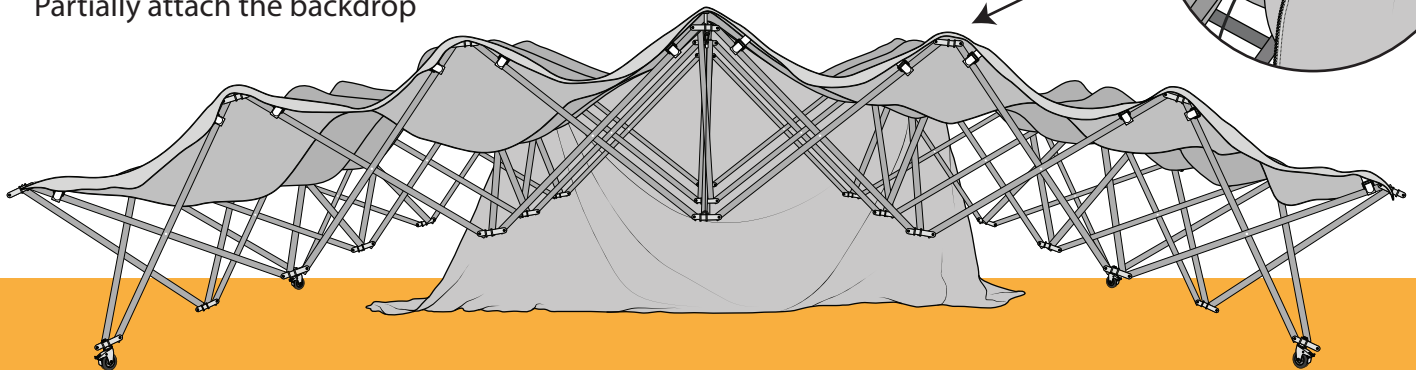

9

Connect the power  
poles to the middle  
joint

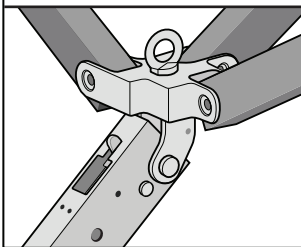

For the structure with 3 side joints, use the connection  
provided with the poles

10

Lift the structure on the poles

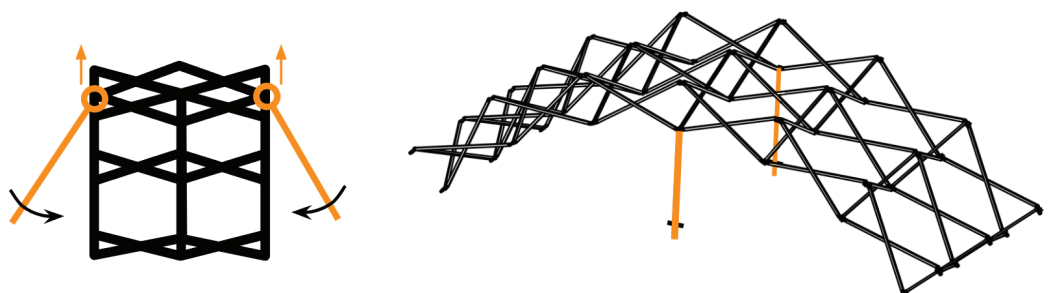

11

Unlock the break

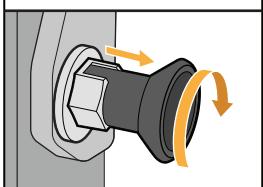

12

Lift the structure thanks to the power poles

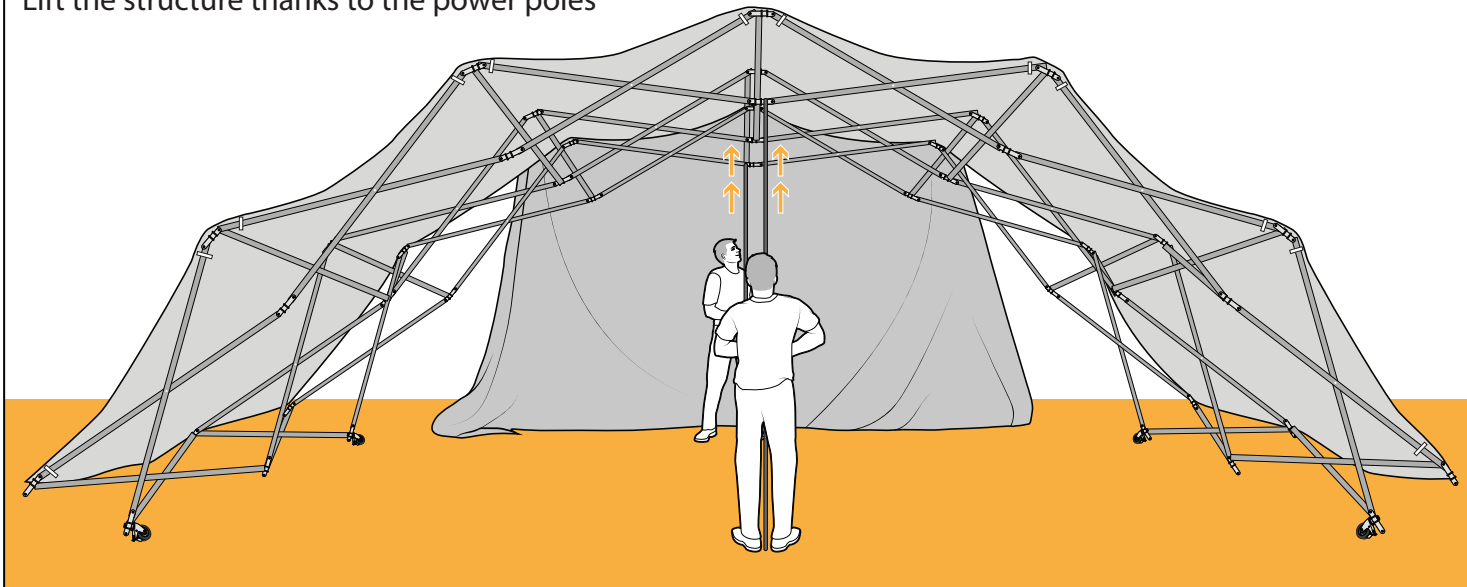

**QUICK TIPS!**

*It should be attached to the two ground eyebolts, at the middle of the struture*

13

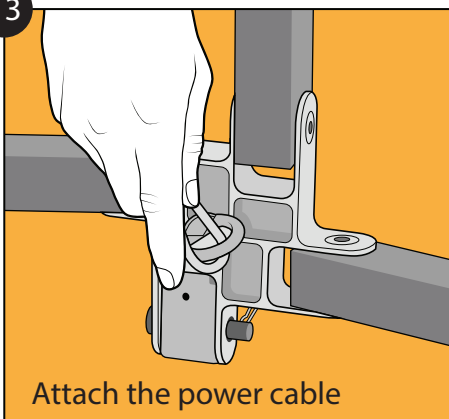

Attach the power cable

14

Disconnect the power poles from the structure

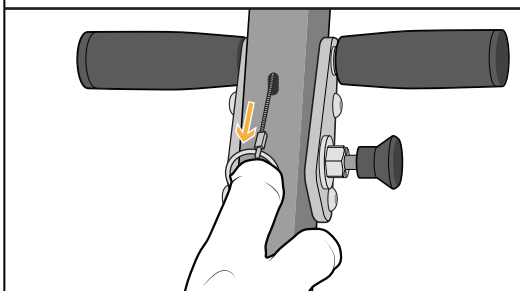

15

Close the power poles

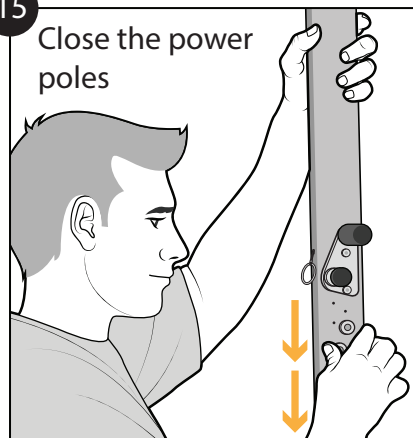

16

Secure the locking cables

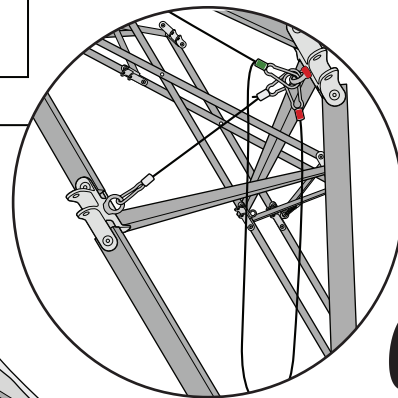
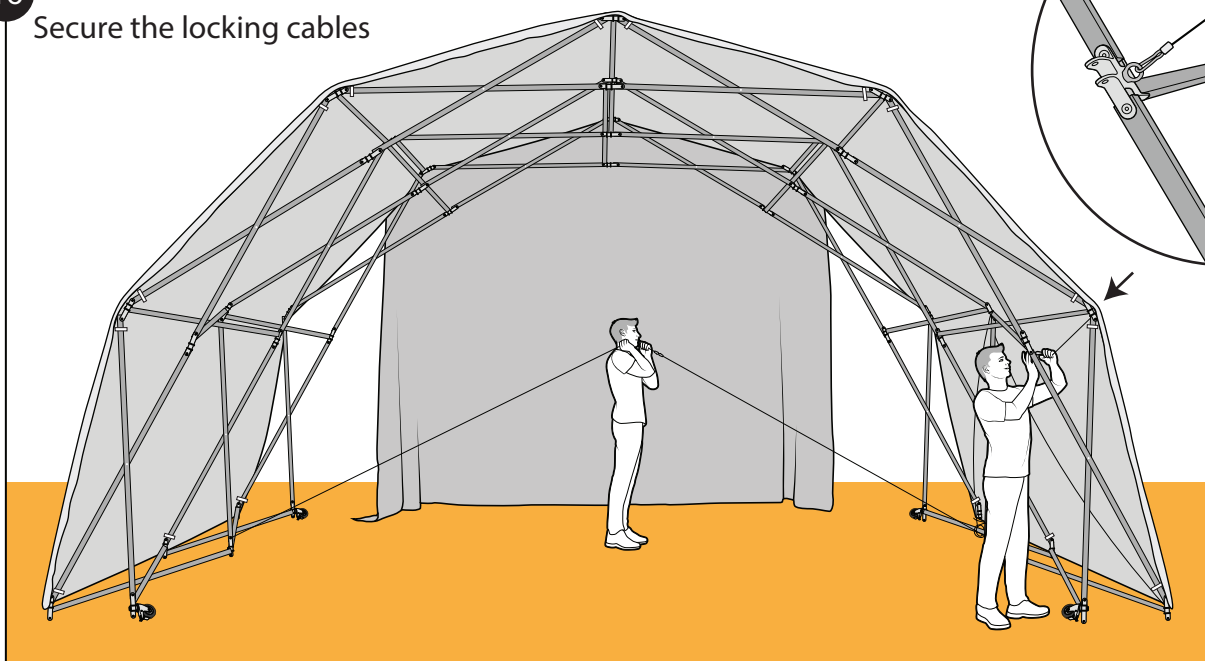

**QUICK TIPS!**

*There is 2 long locking cables (green carabiner) to secure to the red eyebolts and 6 short locking cables to secure the opposite eyebolts*

**QUICK TIPS!**

*Lift the power poles cable to close the structure farther, till it allows the connection of the cables*

*When cables are secured, the powerpole cable can be removed*

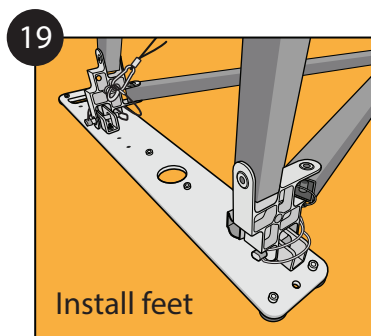

*Make sure that the structure is well placed after this step*

*The feet should be flat on the ground*

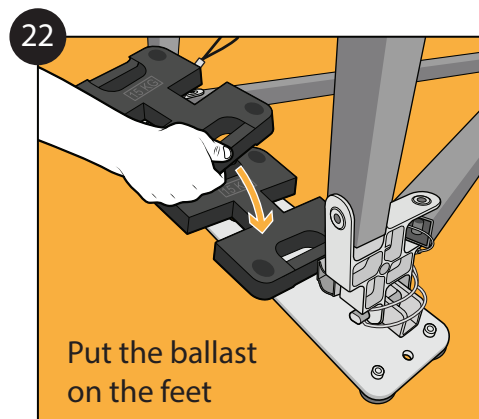
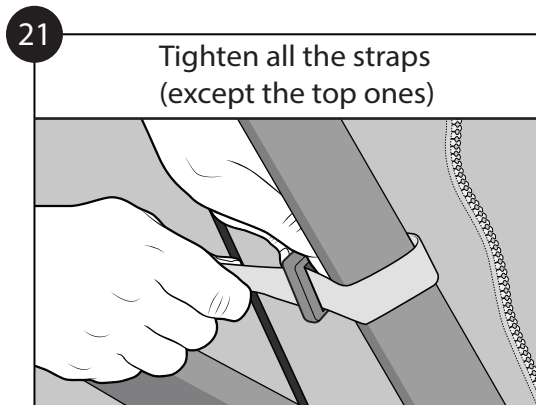
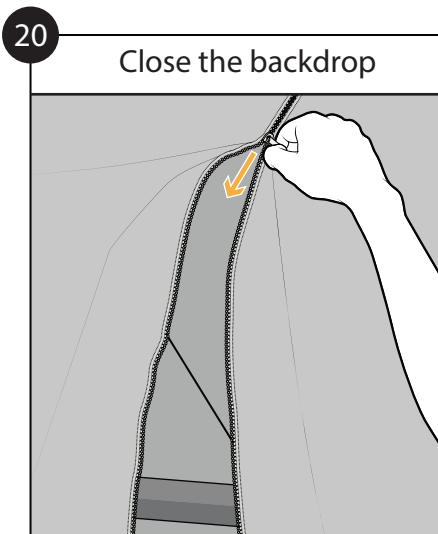

*Check the technical sheet to know the necessary ballast*

<https://www.konligo.com/resources/>

## INSTRUCTION TO CLOSE



*Don't forget to **remove all the safety cables** before folding the structure and to **loosen the straps**. Otherwise you might damage components.*

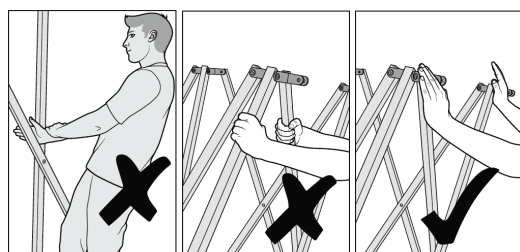

*When closing, don't put your hands between the beams*



*To fold the structure, you don't need power poles. Just lift and pull one side of the structure outward*

